

## Sechskantschlüssel vergütet

Socket wrenches

Clés mâles condées pour vis à six pans creux, cémenté

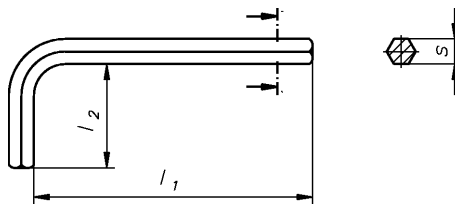

## DIN 911

s	1,5	2	2,5	3	4	5	6	8	10	12	14	17	19	22	27
l 1	45	50	56	63	71	80	90	100	112	125	140	160	180	200	250
l 2	14	16	18	20	25	28	32	36	40	45	55	60	70	80	100

## WGR 1597 000

s mm	für 912	für 913	für 7984	für 7991	Inhalt Stck	€ 100 Stck
1,5	M1,6-2	M3	-	-	100	9,67
2,0	M2,5	M4	M3	M3	100	9,94
2,5	M3	M5	M4	M4	100	11,00
3,0	M4	M6	M5	M5	100	13,89
4,0	M5	M8	M6	M6	100	21,89
5,0	M6	M10	M8	M8	100	33,94
6,0	M8	M12-14	M10	M10	100	48,00
8,0	M10	M16	M12	M12	50	92,89
10,0	M12	M18-20	M14	M14-16	50	157,78
12,0	M14-16	M22-24	M16-18	M18-20	25	267,56
14,0	M18	-	M20-22	M22-24	20	370,83
17,0	M20-22	-	M24	-	10	625,83
19,0	M24-27	-	-	-	10	1640,17
22,0	M30	-	-	-	10	1641,83
27,0	M36	-	-	-	10	3124,56