

Einschraubmuttern mit Schlitz

Slotted anchor nut acc. DIN 7965

Ecrous à insertion avec fente

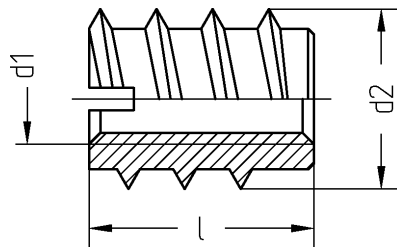

DIN 7965

WGR 2287 000

d1	d2	l	Inhalt	€
M	mm	mm	Stück	100 Stück
4,0	8,0	8	2000	5,61
4,0	8,0	10	2000	6,08
4,0	8,0	12	2000	6,60
5,0	8,0	8	1000	7,36
5,0	8,0	10	1000	7,70
5,0	10,0	10	1000	8,08
5,0	10,0	12	1000	8,69
5,0	10,0	15	1000	9,98
6,0	10,0	10	1000	8,22

d1	d2	l	Inhalt	€
M	mm	mm	Stück	100 Stück
6,0	10,0	12	1000	8,74
6,0	10,0	15	500	11,12
6,0	12,0	10	1000	9,98
6,0	12,0	12	1000	10,07
6,0	12,0	15	500	11,35
6,0	12,0	18	500	12,02
6,0	12,0	20	400	13,59
6,0	12,0	25	400	15,87
8,0	12,0	15	1000	27,50

Einschraubmuttern mit Schlitz

Slotted anchor nut acc. DIN 7965

Ecrous à insertion avec fente

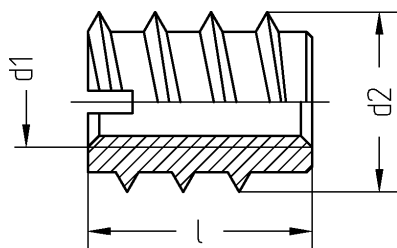

DIN 7965

WGR 2287 000

d1	d2	l	Inhalt	€
M	mm	mm	Stück	100 Stück
8,0	12,0	18	1000	31,73
8,0	12,0	20	1000	35,20
8,0	14,0	14	500	29,00
8,0	14,0	15	400	30,50
8,0	14,0	18	400	34,00
8,0	16,0	18	250	42,04
8,0	16,0	23	250	48,69

d1	d2	l	Inhalt	€
M	mm	mm	Stück	100 Stück
8,0	16,0	30	750	126,83
10,0	16,0	18	250	45,03
10,0	18,0	25	250	173,14
10,0	18,5	15	250	54,39
10,0	18,5	20	250	164,35
10,0	18,5	25	250	195,94

WGR 2287

001 galv. verzinkt • zinc plated • galvanisé

d1 M	d2 mm	l mm	Inhalt Stück	€ 100 Stück
4,0	6,5	8	2000	24,75
4,0	8,0	8	2000	5,89
4,0	8,0	10	2000	6,18
4,0	8,0	12	2000	6,65
5,0	8,0	8	2500	22,52
5,0	8,0	10	1000	15,68
5,0	10,0	8	1000	16,33
5,0	10,0	10	1000	17,58
5,0	10,0	12	1000	9,45
6,0	10,0	12	1000	11,02
6,0	10,0	16	1000	45,79
6,0	12,0	10	1000	36,15
6,0	12,0	12	1000	10,45

d1 M	d2 mm	l mm	Inhalt Stück	€ 100 Stück
6,0	12,0	15	500	12,11
6,0	12,0	18	500	33,00
6,0	12,0	20	500	37,50
6,0	12,0	25	1000	41,50
8,0	14,0	14	500	31,50
8,0	14,0	15	400	34,00
8,0	14,0	18	400	37,50
8,0	16,0	18	250	48,17
8,0	16,0	23	250	52,20
10,0	16,0	18	250	48,17
10,0	18,5	20	250	180,74
10,0	18,5	25	1000	228,71