

Passfedern Form A

Parallel keys, deep pattern
Clavettes parallèles fixées par vis

DIN 6885

Form A
rundstirnig

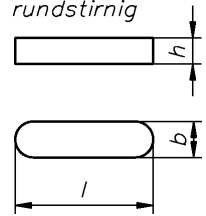

b	3	4	5	6	8	10	12	14	16	18	20	22	25
h	3	4	5	6	7	8	8	9	10	11	12	14	14

WGR 1673 000

b	l	€	b	l	€
mm	mm	100 Stck	mm	mm	100 Stck
3,0	12	8,08	3,0	20	8,08
3,0	14	7,76	3,0	22	8,08
3,0	16	7,84	3,0	25	8,28
3,0	18	7,84	4,0	12	7,96

Passfedern Form A

Parallel keys, deep pattern
Clavettes parallèles fixées par vis

Form A
rundstirrig

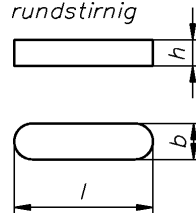

DIN 6885

WGR 1673 000

b mm	l mm	€ 100 Stck	b mm	l mm	€ 100 Stck
4,0	14	7,72	8,0	20	11,92
4,0	16	7,76	8,0	22	12,24
4,0	18	7,76	8,0	25	12,68
4,0	20	8,12	8,0	28	13,52
4,0	22	8,12	8,0	30	13,44
4,0	25	8,32	8,0	32	13,92
4,0	28	8,32	8,0	36	14,16
4,0	30	8,60	8,0	40	15,00
4,0	32	8,60	8,0	45	15,60
4,0	36	8,84	8,0	50	16,20
4,0	40	9,04	8,0	56	16,72
5,0	12	8,16	8,0	63	19,44
5,0	14	7,76	10,0	20	15,80
5,0	16	7,96	10,0	22	15,80
5,0	18	7,96	10,0	25	15,84
5,0	20	8,20	10,0	28	17,08
5,0	22	8,20	10,0	30	17,80
5,0	25	8,60	10,0	32	17,40
5,0	28	8,60	10,0	36	18,36
5,0	30	8,88	10,0	40	19,28
5,0	32	8,88	10,0	45	20,24
5,0	36	9,16	10,0	50	21,16
5,0	40	9,32	10,0	56	23,16
6,0	16	9,24	10,0	63	25,00
6,0	18	9,24	10,0	70	29,04
6,0	20	9,60	12,0	25	24,00
6,0	22	9,60	12,0	28	19,00
6,0	25	10,08	12,0	30	24,36
6,0	28	10,08	12,0	32	24,36
6,0	30	10,52	12,0	36	25,44
6,0	32	10,52	12,0	40	26,60
6,0	36	10,92	12,0	45	24,56
6,0	40	11,20	12,0	50	25,92
6,0	45	11,64	12,0	56	31,04
6,0	50	12,16	12,0	63	33,80

Kongerslev-Fasterners Aps

Tlf: +45 75154999

Passfedern Form A

Parallel keys, deep pattern

Clavettes parallèles fixées par vis

Form A
rundstirnig

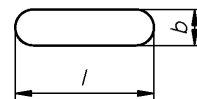
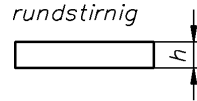

DIN 6885

WGR 1673 000

b mm	l mm	€ 100 Stck
12,0	70	37,00
12,0	80	41,16
12,0	90	45,28
12,0	100	49,48
14,0	32	28,64
14,0	36	29,96
14,0	40	31,44
14,0	45	33,00
14,0	50	34,80
14,0	56	36,96
14,0	63	44,28
14,0	70	46,88
14,0	80	52,20
14,0	90	57,60
14,0	100	63,00
16,0	40	48,00
16,0	45	50,36
16,0	50	52,72
16,0	56	58,24
16,0	63	61,80
16,0	70	63,28
16,0	80	69,32
16,0	90	76,68
16,0	100	83,00
18,0	50	57,84
18,0	56	60,88
18,0	63	64,92
18,0	70	84,56

b mm	l mm	€ 100 Stck
18,0	80	92,64
18,0	90	98,44
18,0	100	103,80
18,0	110	109,88
18,0	125	118,12
20,0	56	78,12
20,0	63	84,80
20,0	70	86,92
20,0	80	95,32
20,0	90	104,84
20,0	100	114,36
20,0	110	125,36
20,0	125	139,28
22,0	80	116,28
22,0	90	127,52
22,0	100	144,08
22,0	110	161,88
22,0	125	179,80
22,0	140	197,68
22,0	160	222,00
25,0	80	144,48
25,0	90	157,72
25,0	100	171,52
25,0	110	184,88
25,0	125	205,28
25,0	140	226,12
25,0	160	580,00