

Sechskantmuttern 1,5 d hoch Kl. 10

Hexagon nuts 1.5 d

Ecrous à six pans, hauteur 1,5 d

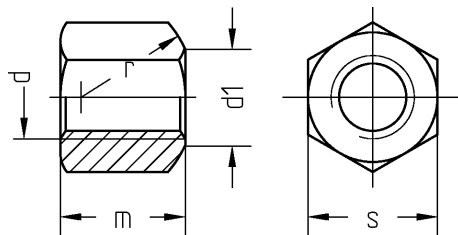

DIN 6330

d	M 8	M 10	M 12	M 16	M 20	M 24	M 30	M 36
d1	9	11,5	14	18	22	26	32	38
m	12	15	18	24	30	36	45	54
s	13	17(16)	19(18)	24	30	36	46	55
r	11	15	17	22	27	32	41	50

WGR 0719 000

d	Inhalt	€
mm	Stck	100 Stck
M 8	500	15,11
M 10	100	18,10
M 12	100	23,80
M 16	50	63,47

d	Inhalt	€
mm	Stck	100 Stck
M 20	25	121,87
M 24	25	173,78
M 30	50	868,89
M 36	25	1208,89