

Senkkerbnägler 6.8

Grooved pins with countersunk head

Clous cannelées à tête fraisée

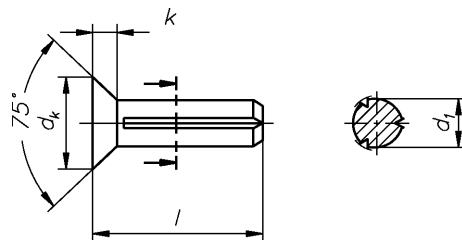

DIN 1477 **DIN-EN-ISO 8747**

d1	2	2,5	3	4	5	6
dk	3,7	4,6	5,45	7,25	9,1	10,8

WGR 1646 000

d mm	l mm	Inhalt Stck	€ 100 Stck
2,0	3	1000	4,49
2,0	4	1000	4,49
2,0	5	1000	4,49
2,0	6	1000	4,49
2,0	7	1000	4,67
2,0	8	1000	4,67
2,0	10	1000	4,67
2,5	3	1000	4,67
2,5	4	1000	4,67
2,5	5	1000	4,67
2,5	6	1000	4,67
2,5	7	1000	4,80
2,5	8	1000	4,80
2,5	10	1000	4,80
3,0	4	1000	5,20
3,0	5	1000	5,20
3,0	6	1000	5,20
3,0	7	1000	5,20
3,0	8	1000	5,33
3,0	10	1000	5,33
3,0	12	1000	5,33
3,0	15	1000	5,87
3,0	18	1000	5,87
4,0	6	1000	7,69
4,0	7	1000	7,69
4,0	8	1000	7,69

d mm	l mm	Inhalt Stck	€ 100 Stck
4,0	10	1000	7,69
4,0	12	1000	7,82
4,0	15	1000	8,36
4,0	18	1000	9,16
4,0	20	1000	9,16
5,0	7	1000	9,82
5,0	8	1000	9,82
5,0	10	1000	9,82
5,0	12	1000	10,27
5,0	15	1000	11,16
5,0	18	1000	11,96
5,0	20	1000	11,96
5,0	22	1000	13,24
5,0	25	1000	13,51
6,0	7	1000	13,24
6,0	8	1000	13,24
6,0	10	1000	13,51
6,0	12	1000	14,89
6,0	15	1000	16,49
6,0	18	1000	18,13
6,0	20	1000	18,13
6,0	22	1000	19,11
6,0	25	1000	19,78
6,0	28	500	22,31
6,0	30	500	22,31