

Knebelkerbstifte 6.8

Grooved pins, third length centre grooved
Goupilles cannelées bombées

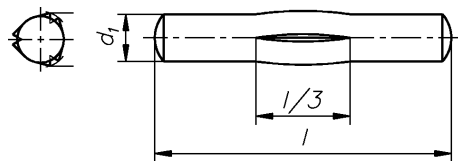

DIN 1475 DIN-EN-ISO 8742

d1	2	2,5	3	4	5	6	8
----	---	-----	---	---	---	---	---

WGR 1644 000

d mm	l mm	Inhalt Stck	€ 100 Stck	d mm	l mm	Inhalt Stck	€ 100 Stck
2,0	4	1000	4,22	3,0	16	1200	5,47
2,0	5	1000	4,22	3,0	18	1000	5,47
2,0	6	1000	4,22	3,0	20	1000	5,91
2,0	8	1000	4,27	3,0	22	1000	5,91
2,0	10	1000	4,27	3,0	24	1000	5,96
2,0	12	1000	4,44	3,0	26	1000	6,13
2,0	14	1000	4,44	3,0	28	1000	6,13
2,0	16	1000	4,44	3,0	30	1000	6,18
2,0	18	1000	4,44	4,0	6	1000	6,09
2,0	20	1000	4,93	4,0	8	1000	6,27
2,0	22	1000	4,93	4,0	10	1000	6,40
2,0	24	1000	5,24	4,0	12	1000	6,58
2,0	26	1000	5,24	4,0	14	1000	6,67
2,0	28	1000	5,33	4,0	16	1000	6,76
2,0	30	1000	5,38	4,0	18	1000	6,85
2,5	6	1000	4,89	4,0	20	1000	6,98
2,5	8	1000	4,89	4,0	22	1000	7,16
2,5	10	1000	4,93	4,0	24	1000	7,24
2,5	12	1000	5,11	4,0	26	1000	7,33
2,5	14	1000	5,11	4,0	28	1000	7,47
2,5	16	1000	5,24	4,0	30	1000	7,60
2,5	18	1000	5,24	4,0	32	1000	7,91
2,5	20	1000	5,38	4,0	36	1000	8,22
2,5	22	1000	5,42	4,0	40	1000	8,62
2,5	24	1000	5,47	4,0	45	1000	9,64
2,5	26	1000	5,47	5,0	8	1000	7,24
2,5	28	1000	5,69	5,0	10	1000	7,42
2,5	30	1000	5,69	5,0	12	1000	7,64
3,0	6	1000	5,02	5,0	14	1000	7,87
3,0	8	1000	5,07	5,0	16	1000	8,04
3,0	10	1000	5,20	5,0	18	1000	8,27
3,0	12	1000	5,20	5,0	20	500	8,53
3,0	14	1000	5,47	5,0	22	500	8,76

[Kongerslev-Fasteners Aps](http://WWW.TORX.DK)

Tlf: +45 75154999

Knebelkerbstifte 6.8

Grooved pins, third length centre grooved
Goupilles cannelées bombées

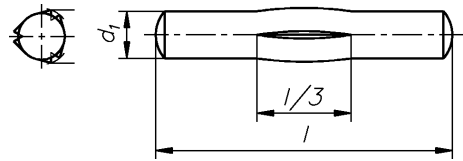

DIN 1475 DIN-EN-ISO 8742

WGR 1644 000

d mm	l mm	Inhalt Stck	€ 100 Stck
5,0	24	500	8,98
5,0	26	500	9,33
5,0	28	500	9,69
5,0	30	500	10,09
5,0	32	500	10,67
5,0	36	500	11,11
5,0	40	500	11,64
5,0	45	100	12,40
6,0	10	1000	10,18
6,0	12	1000	10,36
6,0	14	1000	10,62
6,0	16	1000	10,89
6,0	18	1000	11,20
6,0	20	1000	11,51
6,0	22	1000	11,87
6,0	24	1000	12,31
6,0	26	500	12,62
6,0	28	500	12,98
6,0	30	500	13,33
6,0	32	500	13,91
6,0	36	500	14,40
6,0	40	500	15,07

d mm	l mm	Inhalt Stck	€ 100 Stck
6,0	45	500	16,09
6,0	50	500	17,24
6,0	55	250	18,44
6,0	60	250	19,73
8,0	12	500	15,87
8,0	14	500	16,31
8,0	16	500	16,71
8,0	18	500	17,20
8,0	20	500	17,64
8,0	22	500	18,13
8,0	24	500	18,58
8,0	26	500	19,02
8,0	28	250	19,47
8,0	30	250	19,91
8,0	32	250	21,38
8,0	36	250	22,31
8,0	40	250	23,69
8,0	45	250	26,31
8,0	50	250	27,96
8,0	55	100	29,78
8,0	60	100	32,71