

Steckkerbstifte 6.8

Grooved pins, half length reverse taper grooved
Goupilles entaillées, à insertion

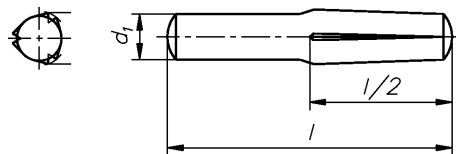

DIN 1474 DIN-EN-ISO 8741

d1	2	2,5	3	4	5	6	8
----	---	-----	---	---	---	---	---

WGR 1643 000

d mm	l mm	Inhalt Stck	€ 100 Stck	d mm	l mm	Inhalt Stck	€ 100 Stck
2,0	4	1000	4,22	3,0	16	1000	5,47
2,0	5	1000	4,22	3,0	18	1000	5,47
2,0	6	1000	4,22	3,0	20	950	5,91
2,0	8	1000	4,27	3,0	22	1000	5,91
2,0	10	1000	4,27	3,0	24	1000	5,96
2,0	12	1000	4,44	3,0	26	1000	6,13
2,0	14	1000	4,44	3,0	28	1000	6,13
2,0	16	1000	4,44	3,0	30	1000	6,18
2,0	18	1000	4,44	4,0	6	1000	6,09
2,0	20	1000	4,93	4,0	8	1000	6,27
2,0	22	1000	4,93	4,0	10	1000	6,40
2,0	24	1000	5,24	4,0	12	1000	6,58
2,0	26	1000	5,24	4,0	14	1000	6,67
2,0	28	1000	5,33	4,0	16	1000	6,76
2,0	30	1000	5,38	4,0	18	1000	6,85
2,5	6	1000	4,89	4,0	20	1000	6,98
2,5	8	1000	4,89	4,0	22	1000	7,16
2,5	10	1000	4,93	4,0	24	1000	7,24
2,5	12	1000	5,11	4,0	26	1000	7,33
2,5	14	1000	5,11	4,0	28	1000	7,47
2,5	16	1000	5,24	4,0	30	1000	7,60
2,5	18	1000	5,24	4,0	32	1000	7,91
2,5	20	1000	5,38	4,0	36	1000	8,22
2,5	22	1000	5,42	4,0	40	1000	8,62
2,5	24	1000	5,47	4,0	45	1000	9,64
2,5	26	1000	5,47	5,0	8	1000	7,24
2,5	28	1000	5,69	5,0	10	1000	7,42
2,5	30	1000	5,69	5,0	12	1000	7,64
3,0	6	1000	5,02	5,0	14	1000	7,87
3,0	8	1000	5,07	5,0	16	1000	8,04
3,0	10	1000	5,20	5,0	18	1000	8,27
3,0	12	1000	5,20	5,0	20	1000	8,53
3,0	14	1000	5,47	5,0	22	1000	8,76

[Kongerslev-Fasteners Aps](http://WWW.TORX.DK)

Tlf: +45 75154999

Steckkerbstifte 6.8

Grooved pins, half length reverse taper grooved
Goupilles entaillées, à insertion

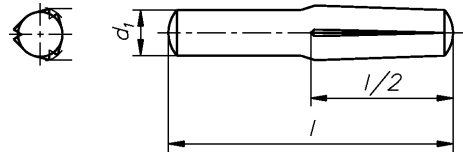

DIN 1474 DIN-EN-ISO 8741

WGR 1643 000

d mm	l mm	Inhalt Stck	€ 100 Stck
5,0	24	1000	8,98
5,0	26	1000	9,33
5,0	28	1000	9,69
5,0	30	500	10,09
5,0	32	500	10,67
5,0	36	500	11,11
5,0	40	500	11,64
5,0	45	500	12,40
6,0	10	500	10,18
6,0	12	500	10,36
6,0	14	500	10,62
6,0	16	500	10,89
6,0	18	500	11,20
6,0	20	500	11,51
6,0	22	500	11,87
6,0	24	500	12,31
6,0	26	500	12,62
6,0	28	500	12,98
6,0	30	500	13,33
6,0	32	1000	13,91
6,0	36	500	14,40
6,0	40	500	15,07

d mm	l mm	Inhalt Stck	€ 100 Stck
6,0	45	500	16,09
6,0	50	500	17,24
6,0	55	500	18,44
6,0	60	500	19,73
8,0	12	500	15,87
8,0	14	500	16,31
8,0	16	500	16,71
8,0	18	500	17,20
8,0	20	500	17,64
8,0	22	500	18,13
8,0	24	500	18,58
8,0	26	500	19,02
8,0	28	250	19,47
8,0	30	250	19,91
8,0	32	250	21,38
8,0	36	250	22,31
8,0	40	250	23,69
8,0	45	250	26,31
8,0	50	250	27,96
8,0	55	250	29,78
8,0	60	100	32,71