

### Federstecker, einfach (ähnlich DIN)

Spring Cotters of a bolt  
Goupilles beta simples

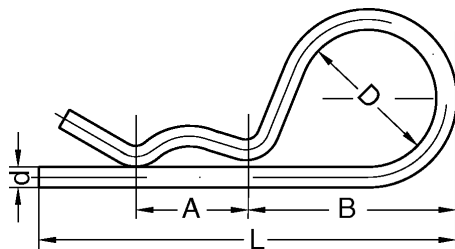

**DIN 11024**

d	2,0	3,0	4,0	5,0	6,0	7,0
L	50	60	60	85	105	105
D	10	18	20	24	30	30
Lochdurchmesser	2,5	3,5	4,5	6,0	7,0	8,0
Außendurchmesser	9-14	10-16	16-20	20-28	28-40	28-45

### WGR 2064

**001** galv. verzinkt • zinc plated • galvanisé

d mm	Inhalt Stck	€ 100 Stck
2,0	100	4,80
3,0	100	8,44
4,0	100	12,60

d mm	Inhalt Stck	€ 100 Stck
5,0	100	24,72
6,0	50	44,48
7,0	50	77,56

### Federstecker, doppelt

Spring Cotters of a bolt, double  
Goupilles beta doubles

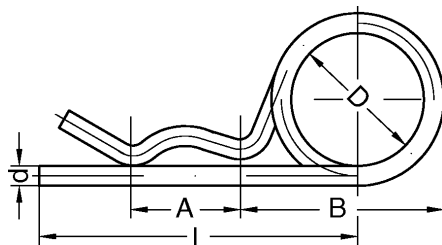

**DIN 11024**

d	2,25	2,8	3,6	5,0	5,6	6,3	7,0
L	50	48	62	92	120	130	130
D	10	19	16	26	30	30	30
Lochdurchmesser	2,5	3,2	4,0	5,0	6,3	7,0	8,0
Außendurchmesser	8-14	18-22	14-20	18-30	24-36	26-40	24-40

### WGR 2068

**001** galv. verzinkt • zinc plated • galvanisé

d mm	Inhalt Stck	€ 100 Stck
2,5	100	15,88

d mm	Inhalt Stck	€ 100 Stck
3,2	100	16,40

**Federstecker, dobbelt**

Spring Cotter of a bolt, double  
Goupilles beta doubles

**DIN 11024**

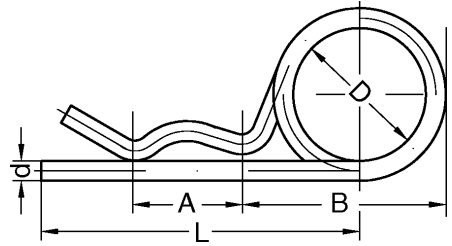

**WGR 2068**

**001** galv. verzinkt • zinc plated • galvanisé

d mm	Inhalt Stck	€ 100 Stck
4,0	100	23,72
5,0	100	46,80
6,3	50	80,64

d mm	Inhalt Stck	€ 100 Stck
7,0	100	122,80
8,0	50	155,40