

Senkschrauben mit Innensechskant A2

Hexagon socket countersunk head screws

Vis à tête à six-pans creux fraisée

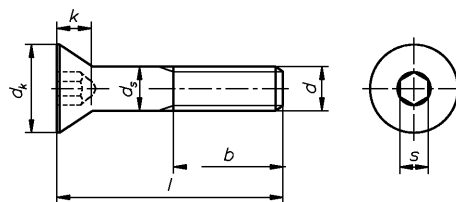

DIN 7991 DIN-EN-ISO 10642

| d | M 3 | M 4 | M 5 | M 6 | M 8 | M 10 | M 12 | M 16 |
|----|-----|-----|-----|-----|-----|------|------|------|
| b | 12 | 14 | 16 | 18 | 22 | 26 | 30 | 38 |
| dk | 6 | 8 | 10 | 12 | 16 | 20 | 24 | 30 |
| ds | 3 | 4 | 5 | 6 | 8 | 10 | 12 | 16 |
| k | 1,7 | 2,3 | 2,8 | 3,3 | 4,4 | 5,5 | 6,5 | 7,5 |
| s | 2 | 2,5 | 3 | 4 | 5 | 6 | 8 | 10 |

WGR 3423 000

| d | l | Inhalt | € |
|-----|----|--------|----------|
| mm | mm | Stck | 100 Stck |
| M 3 | 6 | 2000 | 1,94 |
| M 3 | 8 | 2000 | 2,22 |
| M 3 | 10 | 2000 | 2,50 |
| M 3 | 12 | 2000 | 2,72 |
| M 3 | 14 | 2000 | 3,28 |
| M 3 | 16 | 1000 | 3,33 |
| M 3 | 20 | 1000 | 4,17 |
| M 3 | 25 | 1000 | 6,67 |
| M 3 | 30 | 1000 | 10,00 |
| M 4 | 6 | 2000 | 2,56 |
| M 4 | 8 | 1000 | 3,22 |
| M 4 | 10 | 1000 | 3,56 |
| M 4 | 12 | 1000 | 3,94 |
| M 4 | 16 | 1000 | 4,33 |
| M 4 | 20 | 500 | 4,61 |
| M 4 | 25 | 500 | 5,78 |
| M 4 | 30 | 500 | 7,50 |
| M 4 | 35 | 200 | 9,44 |
| M 4 | 40 | 200 | 10,56 |
| M 5 | 8 | 1000 | 4,89 |
| M 5 | 10 | 500 | 5,11 |
| M 5 | 12 | 500 | 5,44 |
| M 5 | 14 | 500 | 7,50 |
| M 5 | 16 | 500 | 6,44 |
| M 5 | 20 | 500 | 6,94 |
| M 5 | 25 | 200 | 8,50 |
| M 5 | 30 | 200 | 9,72 |
| M 5 | 35 | 200 | 11,22 |

| d | l | Inhalt | € |
|-----|----|--------|----------|
| mm | mm | Stck | 100 Stck |
| M 5 | 40 | 200 | 11,94 |
| M 5 | 45 | 200 | 15,44 |
| M 5 | 50 | 200 | 15,89 |
| M 5 | 60 | 200 | 27,22 |
| M 6 | 8 | 500 | 6,33 |
| M 6 | 10 | 500 | 6,89 |
| M 6 | 12 | 500 | 7,50 |
| M 6 | 16 | 200 | 8,06 |
| M 6 | 20 | 200 | 9,83 |
| M 6 | 25 | 200 | 10,61 |
| M 6 | 30 | 200 | 13,78 |
| M 6 | 35 | 200 | 14,00 |
| M 6 | 40 | 200 | 17,00 |
| M 6 | 45 | 100 | 18,94 |
| M 6 | 50 | 100 | 22,00 |
| M 6 | 55 | 100 | 24,50 |
| M 6 | 60 | 100 | 24,94 |
| M 6 | 70 | 100 | 27,72 |
| M 8 | 12 | 500 | 14,56 |
| M 8 | 16 | 500 | 16,67 |
| M 8 | 20 | 500 | 18,28 |
| M 8 | 25 | 200 | 20,61 |
| M 8 | 30 | 200 | 21,33 |
| M 8 | 35 | 200 | 23,89 |
| M 8 | 40 | 200 | 30,56 |
| M 8 | 45 | 200 | 35,00 |
| M 8 | 50 | 200 | 42,94 |
| M 8 | 55 | 200 | 43,94 |

Senkschrauben mit Innensechskant A2

Hexagon socket countersunk head screws

Vis à tête à six-pans creux fraisée

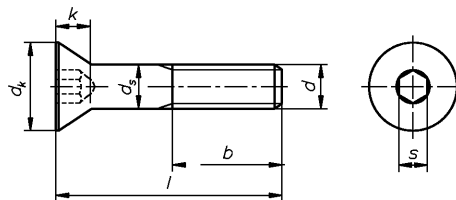

DIN 7991 DIN-EN-ISO 10642

WGR 3423 000

| d mm | l mm | Inhalt Stck | € 100 Stck |
|---------|---------|----------------|---------------|
| M 8 | 60 | 200 | 50,28 |
| M 8 | 70 | 100 | 52,94 |
| M 8 | 80 | 100 | 61,89 |
| M 8 | 100 | 100 | 66,44 |
| M 10 | 16 | 200 | 46,67 |
| M 10 | 20 | 200 | 35,00 |
| M 10 | 25 | 200 | 37,78 |
| M 10 | 30 | 200 | 42,89 |
| M 10 | 35 | 200 | 46,61 |
| M 10 | 40 | 200 | 51,67 |
| M 10 | 45 | 100 | 55,78 |
| M 10 | 50 | 100 | 59,17 |
| M 10 | 55 | 100 | 79,61 |
| M 10 | 60 | 100 | 81,11 |
| M 10 | 70 | 100 | 91,44 |
| M 10 | 80 | 100 | 110,56 |
| M 10 | 90 | 50 | 116,67 |
| M 10 | 100 | 50 | 135,17 |
| M 12 | 20 | 100 | 69,67 |
| M 12 | 25 | 100 | 62,78 |
| M 12 | 30 | 100 | 64,44 |
| M 12 | 35 | 100 | 71,44 |

| d mm | l mm | Inhalt Stck | € 100 Stck |
|---------|---------|----------------|---------------|
| M 12 | 40 | 100 | 76,06 |
| M 12 | 45 | 100 | 88,33 |
| M 12 | 50 | 100 | 115,94 |
| M 12 | 55 | 100 | 133,11 |
| M 12 | 60 | 100 | 147,22 |
| M 12 | 70 | 50 | 155,11 |
| M 12 | 80 | 50 | 169,44 |
| M 12 | 90 | 50 | 205,00 |
| M 12 | 100 | 50 | 224,00 |
| M 16 | 25 | 50 | 313,89 |
| M 16 | 30 | 50 | 350,00 |
| M 16 | 35 | 50 | 361,11 |
| M 16 | 40 | 50 | 377,78 |
| M 16 | 45 | 50 | 382,10 |
| M 16 | 50 | 50 | 385,65 |
| M 16 | 55 | 50 | 398,85 |
| M 16 | 60 | 50 | 405,56 |
| M 16 | 70 | 50 | 502,78 |
| M 16 | 80 | 25 | 566,67 |
| M 16 | 90 | 25 | 633,33 |
| M 16 | 100 | 25 | 722,22 |

Senkschrauben mit Innensechskant A4

Hexagon socket countersunk head screws

Vis à six-pans creux à tête fraisée

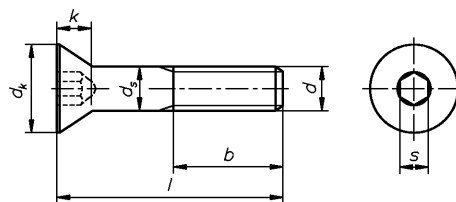

DIN 7991 DIN-EN-ISO 10642

| d | M 4 | M 5 | M 6 | M 8 | M 10 | M 12 | M 16 |
|----|-----|-----|-----|-----|------|------|------|
| b | 14 | 16 | 18 | 22 | 26 | 30 | 38 |
| dk | 8 | 10 | 12 | 16 | 20 | 24 | 30 |
| ds | 4 | 5 | 6 | 8 | 10 | 12 | 16 |
| k | 2,3 | 2,8 | 3,3 | 4,4 | 5,5 | 6,5 | 7,5 |
| s | 2,5 | 3 | 4 | 5 | 6 | 8 | 10 |

WGR 3630 000

| d | l | Inhalt | € |
|-----|----|--------|----------|
| mm | mm | Stck | 100 Stck |
| M 4 | 10 | 1000 | 5,28 |
| M 4 | 12 | 1000 | 6,67 |
| M 4 | 16 | 1000 | 9,11 |
| M 4 | 20 | 500 | 13,33 |
| M 4 | 25 | 500 | 14,17 |
| M 4 | 30 | 500 | 18,44 |
| M 5 | 10 | 500 | 6,50 |
| M 5 | 12 | 500 | 9,17 |
| M 5 | 16 | 500 | 9,72 |
| M 5 | 20 | 500 | 10,00 |
| M 5 | 25 | 200 | 13,61 |
| M 5 | 30 | 200 | 16,11 |
| M 5 | 35 | 200 | 25,56 |
| M 5 | 40 | 200 | 27,00 |
| M 5 | 50 | 200 | 39,44 |
| M 6 | 10 | 500 | 11,67 |
| M 6 | 12 | 500 | 12,00 |
| M 6 | 16 | 200 | 13,44 |
| M 6 | 20 | 200 | 15,83 |
| M 6 | 25 | 200 | 16,67 |
| M 6 | 30 | 200 | 19,94 |
| M 6 | 35 | 200 | 21,11 |
| M 6 | 40 | 200 | 26,11 |
| M 6 | 45 | 100 | 33,89 |
| M 6 | 50 | 100 | 36,94 |
| M 8 | 16 | 500 | 23,39 |
| M 8 | 20 | 500 | 27,22 |
| M 8 | 25 | 200 | 29,83 |

| d | l | Inhalt | € |
|------|-----|--------|----------|
| mm | mm | Stck | 100 Stck |
| M 8 | 30 | 200 | 34,89 |
| M 8 | 35 | 200 | 42,22 |
| M 8 | 40 | 200 | 49,44 |
| M 8 | 45 | 200 | 53,94 |
| M 8 | 50 | 200 | 55,50 |
| M 8 | 60 | 200 | 56,00 |
| M 10 | 20 | 200 | 41,94 |
| M 10 | 25 | 200 | 45,44 |
| M 10 | 30 | 200 | 65,00 |
| M 10 | 35 | 200 | 66,67 |
| M 10 | 40 | 200 | 77,78 |
| M 10 | 45 | 100 | 86,94 |
| M 10 | 50 | 100 | 97,22 |
| M 10 | 60 | 100 | 154,44 |
| M 12 | 20 | 100 | 101,67 |
| M 12 | 25 | 100 | 102,78 |
| M 12 | 30 | 100 | 103,78 |
| M 12 | 35 | 100 | 127,28 |
| M 12 | 40 | 100 | 131,56 |
| M 12 | 45 | 100 | 133,33 |
| M 12 | 50 | 100 | 136,11 |
| M 12 | 60 | 100 | 186,11 |
| M 12 | 70 | 50 | 221,67 |
| M 12 | 80 | 50 | 244,44 |
| M 12 | 100 | 50 | 364,44 |
| M 16 | 25 | 50 | 262,78 |
| M 16 | 30 | 50 | 272,22 |
| M 16 | 35 | 50 | 286,67 |

Senkschrauben mit Innensechskant A4

Hexagon socket countersunk head screws

Vis à six-pans creux à tête fraisée

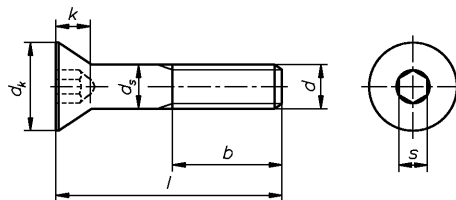

DIN 7991 DIN-EN-ISO 10642

WGR 3630 000

| d | l | Inhalt | € |
|----|----|--------|----------|
| mm | mm | Stck | 100 Stck |

| | | | |
|------|----|----|--------|
| M 16 | 40 | 50 | 422,67 |
|------|----|----|--------|

| | | | |
|------|----|----|--------|
| M 16 | 45 | 50 | 441,89 |
|------|----|----|--------|

| | | | |
|------|----|----|--------|
| M 16 | 50 | 50 | 494,44 |
|------|----|----|--------|

| | | | |
|------|----|----|--------|
| M 16 | 60 | 50 | 622,22 |
|------|----|----|--------|

| d | l | Inhalt | € |
|----|----|--------|----------|
| mm | mm | Stck | 100 Stck |

| | | | |
|------|----|----|--------|
| M 16 | 70 | 50 | 627,78 |
|------|----|----|--------|

| | | | |
|------|----|----|--------|
| M 16 | 80 | 25 | 744,45 |
|------|----|----|--------|

| | | | |
|------|----|----|--------|
| M 16 | 90 | 25 | 772,22 |
|------|----|----|--------|

| | | | |
|------|-----|----|--------|
| M 16 | 100 | 25 | 855,56 |
|------|-----|----|--------|